

正式图 参考图 CUSTOMER DRAWING
The requirements of environmental protection
ROHS2 Halogen free

Mark	ECN NO.	DESCRIPTION	DESIGN	Date:
—	—	NEW VERSION	David Zhou	2014.01.06

SPECIFICATION:

Electrical:

Current Rating:1.5Amp max
Voltage Rating:150VAC max
Insulation Resistance:500 megohms min
Contact Resistance:50 milliohms max
Withstanding Voltage:1000 VAC

Mechanical:

Durability:750 Cycles
Operating Temperature:-40℃~+70℃
Storage Temperature:-50℃~+75℃
Contact Normal Force:100g Minimum
Soldering Temperature:
260+/-5℃,5sec/95%Area be covered
Withstand Temperature: 270+/-5℃,5sec No stick tin melting phenomenon

P/N:

RJ1015W-XXXX-XXXXXXXXX
Model P/N Packing
 B:Tray; R:Tape reel;
Chocolate:
LED Color Options Table
Plating Code:
 00:Gold Flash
 01:6u"
 02:15u"
 03:30u"
 04:50u"
Contacts:
 8C:8Pin Contacts
Plastical Material
 B0:PBT4815 15%GF,UL94-V0 ROHS
 B4:PBT5615 15%GF,UL94-V0 ROHS&H.F
 D6:PA66 30%GF,UL94-V0 ROHS&H.F
 C0:LCP,UL94-V0 ROHS&H.F
Button Color
 01:Black
 02:Red(485c)
 03:White
 04:Yellow(114C)
 08:Gray(Cool Gray2C)

LED Color Options Table

LED Color Options		LED DASH OPTION	Choose
LED 2 (Left)	LED 1(Right)		
Without LED	Without LED	00	
Green	Orange	01	
Orange	Green	02	
Green	Red	03	
Red	Green	04	
Red	Yellow	05	
Orange	Orange/Green	06	
Orange	Green/Orange	07	
Green	No LED	08	
No LED	Yellow/Green	09	

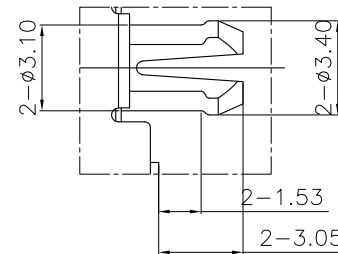
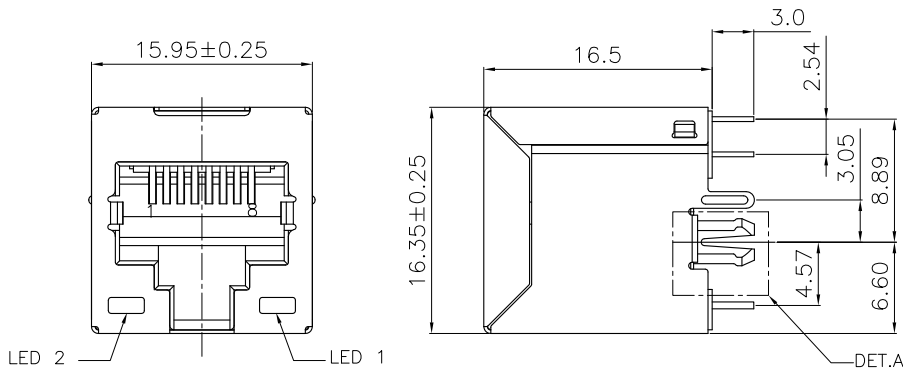
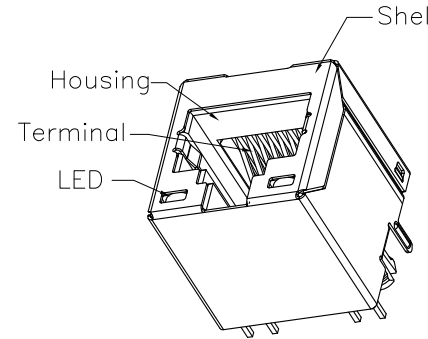

DETAIL
SCALE 2:1

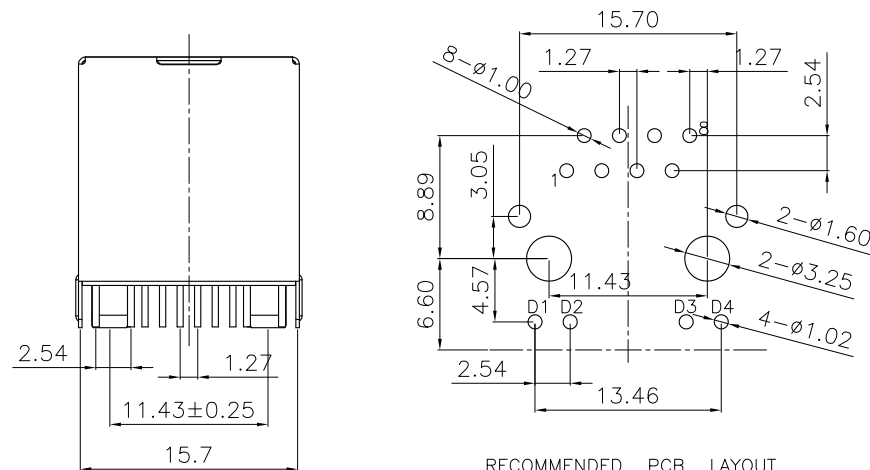

RECOMMENDED PCB LAYOUT
TOP VIEW
TOLERANCE:±0.05mm
PCB THICKNESS: 1.60±0.05mm

NO.	DESCRIPTION	QTY	PARTS MATERIAL	PLATING OR COLOR	REMARK
4	LED	2	-	-	-
3	SHELL	1	Copper Alloy	Nickel Plating	-
2	TERMINAL	8	0.35mm Thickness Copper Alloy,Plated With Gold And Tin In Solder Area.	Selective Gold Plating.(Gold See Part No)	-
1	Housing	1	Choose from P/N	Choose from P/N item color	-

Tolerance	MODEL NAME:RJ45 CONNECTOR	DRAWING: David Zhou
X.X ±0.30	MODEL No:RJ1015W-XXXX-XXXX00X	CHECKED: David Zhou
X.XX ±0.20	REVISION SHEET A0 1/1	APPROVED:Jacky Lee
X.XXX ±0.10		DATE: 2014.01.06
Angle ±3.0°	SCALE:1:1	FILE: CD/LINGYANG
UNIT:mm	菱揚精密有限公司 Ling Yang Precision Co.,Ltd	DWG NO.RJ1015W-A001