

正式图 参考图 CUSTOMER DRAWING  
The requirements of environmental protection  
ROHS2 Halogen free

Mark	ECN NO.	DESCRIPTION	DESIGN	Date:
—	—	NEW VERSION	David Zhou	2013.12.22

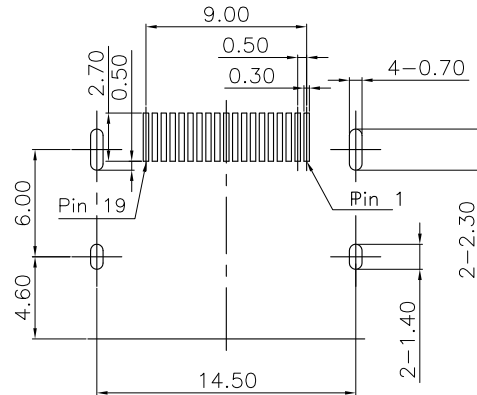

PCB LAYOUT

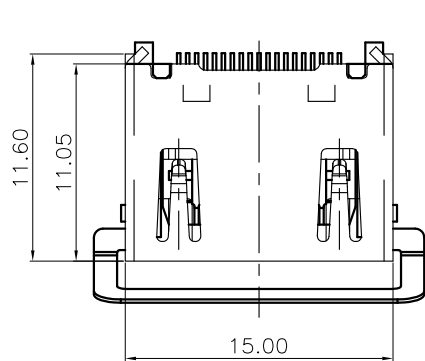
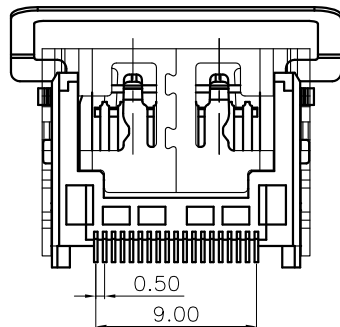
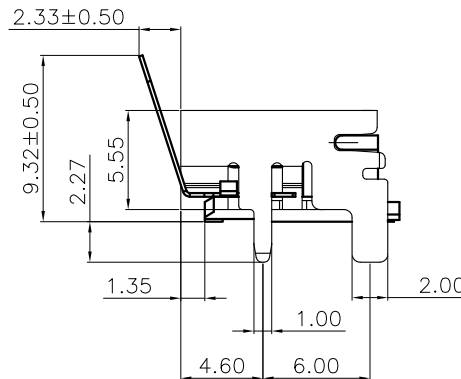
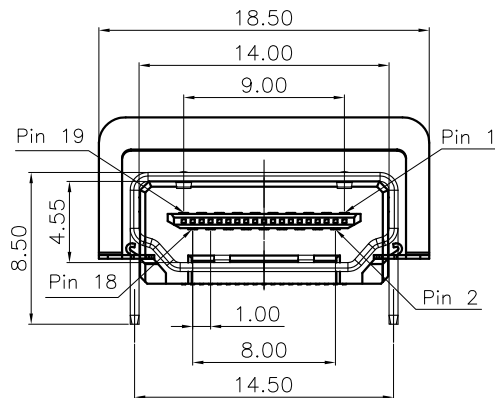

NOTE:  
1.MECHANICAL CHARACTERISTICS  
INSERTION FORCE: 44.1N MAX  
EXTRCTION FORCE: 9.8N MIN, 39.2N MAX  
MATING CYCLE:10000 CYCLES  
2.ELECTRICAL CHARACTERISTICS  
RATING CURRENT: 0.5A  
RATING VOLTAGE: 40V  
CONTACT RESISTANCE: 10 MILLOHMS OHMS MAX  
(EXCLUDING CONDUCTOR RESISTANCE)  
INSULATION RESISTANCE:  
a, UNMATED: 100M OHMS MIN AT 500 VDC  
b, MATED: 10M OHMS MIN AT 150 VDC  
DIELECTRIC WITHSTANDING VOLTAGE: 300V AC/1MINUTE  
OPERATING TEMPERATURE: -20°C---+85°C  
STORAGE TEMPERATURE: -20°C---+65°C

2	C0	LCP 40%G/F UL94V-0	RoHS2&H.F Fit
1	L0	PA9T 30%G/F UL94V-0	RoHS2 Fit
NO.	CODE	MATERIAL	REMARK

TABLE A : Plastical Material

P/N:

HDXXXXX-XXXX-XXXXXXX

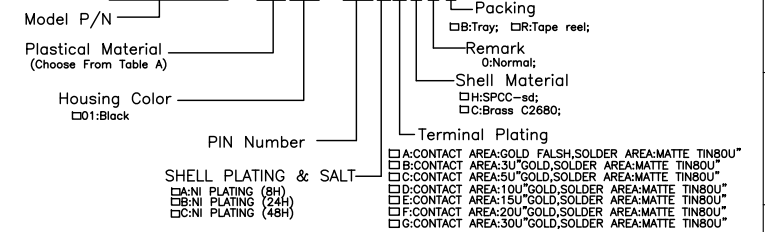

4	SPRING	1	SUS		-
3	SHELL	1	C2680 R-H	NICKEL(xx"min) PLATING OVER ALL.	-
2	TERMINAL	19	C2680 R-H	GOLD FLASH(xx"min) PLATING ON CONTACT AREA AND MATTE TIN(xxU"min) PLATING ON SOLDER AREA,NICKEL(xxU") UNDER PLATING OVER ALL.	-
1	HOUSING	1	LCP	Choose from P/N item color	-
NO.	DESCRIPTION	QTY	PARTS MATERIAL	PLATING OR COLOR	REMARK

Tolerance	MODEL NAME:HDMI A/F TYPE 90度SMT	DRAWING: David Zhou
X.X ±0.30	MODEL No:HD1092W-XXXX-19XXXXX	CHECKED: David Zhou
X.XX ±0.20	SCALE:1:1	APPROVED:Jacky Lee
X.XXX ±0.10	REVISION A0	DATE: 2013.12.22
Angle ±3.0°	SHEET 1/1	FILE: CD/LINGYANG
UNIT:mm	菱揚精密有限公司 Ling Yang Precision Co.,Ltd	DWG NO. HD1092W-A001