

正式图 参考图 CUSTOMER DRAWING
The requirements of environmental protection
ROHS2 Halogen free

Mark	ECN NO.	DESCRIPTION	DESIGN	Date:
—	—	NEW VERSION	David Zhou	2015.06.08
	EN20151022001	Modify the part structure	David Zhou	2015.10.22

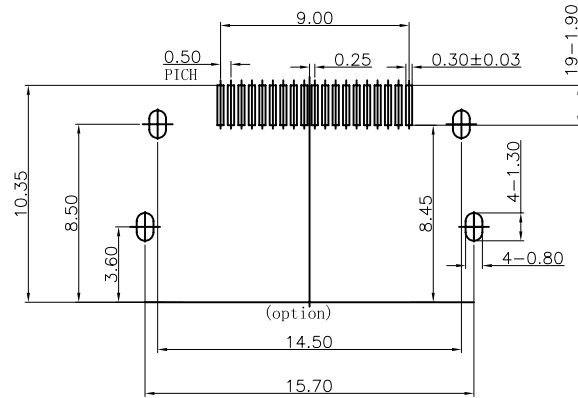
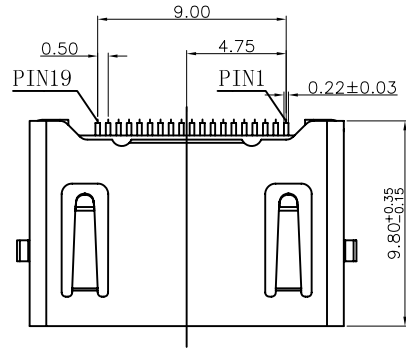

RECOMMENDED PCB LAYOUT (TOP VIEW)
TOLERANCE: ±0.05mm

NOTE:
1.MECHANICAL CHARACTERISTICS
INSERTION FORCE: 44.1N MAX
EXTROCTION FORCE: 9.8N MIN, 39.2N MAX
MATING CYCLE:10000 CYCLES
2.ELECTRICAL CHARACTERISTICS
RATING CURRENT: 0.5A
RATING VOLTAGE: 40V
CONTACT RESISTANCE: 10 MILLOHMS OHMS MAX (EXCLUDING CONDUCTOR RESISTANCE)
INSULATION RESISTANCE:
a, UNMATED: 100M OHMS MIN AT 500 VDC
b, MATED: 10M OHMS MIN AT 150 VDC
DIELECTRIC WITHSTANDING VOLTAGE: 300V AC/1MINUTE
OPERATING TEMPERATURE: -20°C---+85°C
STORAGE TEMPERATURE: -20°C---+65°C

NO.	CODE	MATERIAL	REMARK
2		LCP,UL94-V0	RoHS2&H.F Fit
1	CO		

TABLE A : Plastical Material

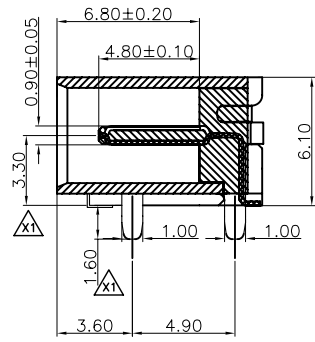
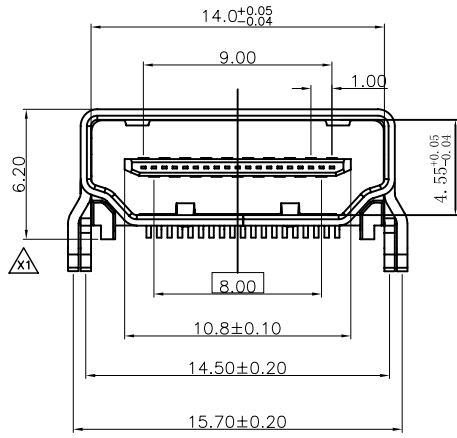

P/N: HD1105W-XXXX-XXXXXXXX
Model P/N _____ Packing
Plastical Material _____ B:Tray; R:Tape reel;
(Choose From Table A) Remark
Housing Color _____ 0:Normal;
 01:Black Shell Material
PIN Number _____ S:S50C
Terminal Plating
SHELL PLATING & SALT _____
 A:CONTACT AREA:30" GOLD,SOLDER AREA:MATTE TIN80"
 B:CONTACT AREA:50" GOLD,SOLDER AREA:MATTE TIN80"
 C:CONTACT AREA:10U" GOLD,SOLDER AREA:MATTE TIN80"
 D:CONTACT AREA:15U" GOLD,SOLDER AREA:MATTE TIN80"
 E:CONTACT AREA:20U" GOLD,SOLDER AREA:MATTE TIN80"
 F:CONTACT AREA:30U" GOLD,SOLDER AREA:MATTE TIN80"

NO.	DESCRIPTION	QTY	PARTS MATERIAL	PLATING OR COLOR	REMARK
3	SHELL	1	S50C	100u"MIN. NICKEL PLATING	T=0.50
2	TERMINAL	19	COPPER ALLOY	GOLD FLASH(0.8U"min) PLATING ON CONTACT AREA AND MATTE TIN(100U"min) PLATING ON SOLDER AREA,NICKEL(50U") UNDER PLATING OVER ALL.	T=0.20
1	HOUSING	1	LCP	Choose from P/N item color	-

Tolerance X.X ±0.30 X.XX ±0.20 X.XXX ±0.10 Angle ±3.0°	MODEL NAME: HDMI CONNECTOR MODEL No: HD1105W-XXXX-19XXXXX	DRAWING: David Zhou CHECKED: David Zhou APPROVED: Jacky Lee DATE: 2015.06.08 FILE: CD/LINGYANG DWG NO. HD1105W-A001
	SCALE: 1:1	REVISION SHEET A1 1/1
UNIT: mm	菱揚精密有限公司 Ling Yang Precision Co.,Ltd	