

正式图 参考图 CUSTOMER DRAWING
The requirements of environmental protection
ROHS2 Halogen free

Mark	ECN NO.	DESCRIPTION	DESIGN	Date:
—	—	INITIAL RELEASE	Carlyle xu	2017.01.05
△1	EN20170207001	Modify the part structure	Carlyle xu	2017.02.07
△2	EN20170221001	Modify the part structure	Carlyle xu	2017.02.21

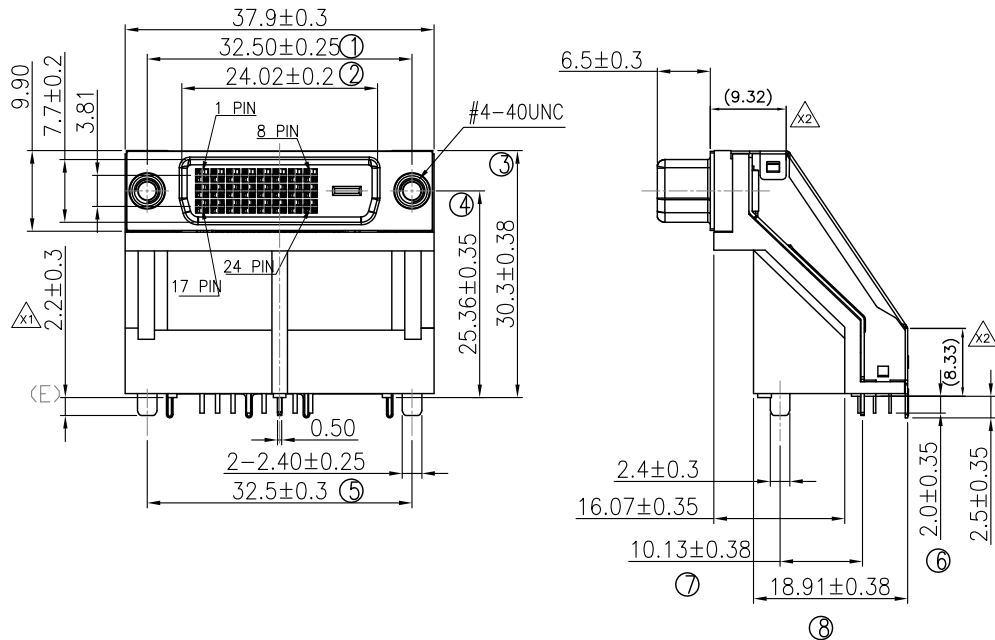

NOTES:
1.Rating:40V AC(rms) 1.5Ampere;
2.Contact Resistance:Before the test≤20Milliohm;
After the test≤50Milliohm;
3.Insulation Resistance:≥1000Megohm(at DC500V±50V);
4.Withstand Voltage:DC500V ,No flashover,No sparkover,
No excess leakage,No breakover;
5.Insertion and Extraction force:45N Max;
6.Extraction force:10~40N;
7.Life test:100 Cycles.
8.Operating Temperature:-25°C~+85°C 85%RH Max;
9.Storage Temperature:-40°C~+85°C 85%RH Max.

NO.	CODE	MATERIAL	COLOR	REMARK
5	L0	LCP 30%G/F UL94V-0	Choose P/N	RoHS2&H.F Fit
4	D6	PA66 30%G/F UL94V-0	Choose P/N	RoHS2&H.F Fit
3	D0	PA66 30%G/F UL94V-0	Choose P/N	RoHS2 Fit
2	B4	PBT 30%G/F UL94V-0	Choose P/N	RoHS2&H.F Fit
1	B0	PBT 30%G/F UL94V-0	Choose P/N	RoHS2 Fit

TABLE A : Plastical Material

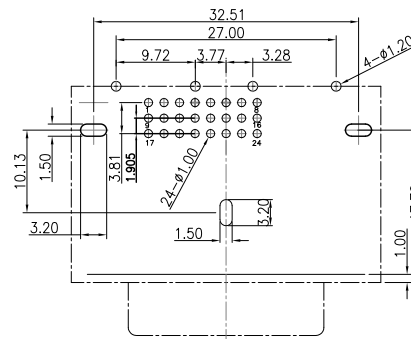
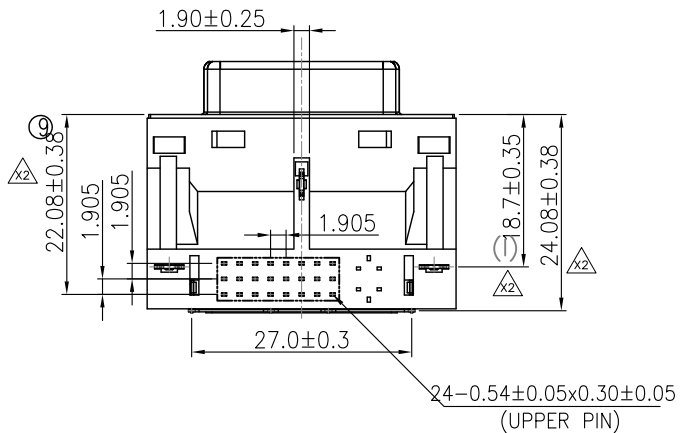

Model P/N: DVI026W-XXXX-XXXXXXX

Plastical Material (Choose From Table A)

Housing Color: 01:Black 02:IVORY

PIN Number: 24:24PIN 25:25PIN 29:29PIN

Product salt mist: A:Nomol; B:24Hours; C:48Hours; C:72Hours;

Packing: B:Tray

Screw: WL:Without screw S1:Attachment screw(4.8mm) S2:Lock screw(4.8mm) F1:Attachment screw(5.8mm) F2:Lock screw(5.8mm)

Plating Code: A:CONTACT AREA:GOLD,FALSH,SOLDER AREA:MATTE TIN80U" B:CONTACT AREA:3U"GOLD,SOLDER AREA:MATTE TIN80U" C:CONTACT AREA:5U"GOLD,SOLDER AREA:MATTE TIN80U" D:CONTACT AREA:10U"GOLD,SOLDER AREA:MATTE TIN80U" E:CONTACT AREA:15U"GOLD,SOLDER AREA:MATTE TIN80U" F:CONTACT AREA:10U"GOLD,SOLDER AREA:MATTE TIN80U" G:CONTACT AREA:15U"GOLD,SOLDER AREA:MATTE TIN80U"

NO.	PART NAME	QTY	PARTS MATERIAL	PLATING OR COLOR	REMARK
7	RIVET	2PCS	COPPER ALLOY	Ni:80u" (Min)	
6	SHIELDING SHELL	1PCS	STAINLESS STEEL T=0.3mm	Ni:80u" (Min)	
5	BOARD LOCK	1PCS	SPCC T=0.5mm	Cu:50u"+Ni:80u" (Min)	
4	SHELL	1PCS	SPCC T=0.5mm	Cu:50u"+Ni:80u" (Min)	
3	TERMINAL	24PCS	COPPER ALLOY T=0.25mm	Au"X"u"+Ni:40u"+Tin80u"	
2	BRACKET	1PCS	CHOOSE FROM TABLE A	Choose from Table P/N color	
1	HOUSING	1PCS	CHOOSE FROM TABLE A	Choose from Table P/N color	

Tolerance	MODEL NAME: DVI CONNECTOR	DRAWING: Carlyle xu
X.X ±0.30	MODEL No:DVI026W-XXXX-XXXXXXX	CHECKED: David zhou
X.XX ±0.20	SCALE:1:1	APPROVED: Jacky Lee
X.XXX ±0.10	REVISION A2	DATE: 2017.01.05
Angle ±3.0°	SHEET 1/1	FILE: F/LINGYANG
UNIT:mm	菱揚精密有限公司 Ling Yang enterprise Co.,Ltd	DWG NO: DVI026W-A001