

正式图 参考图

Mark	ECN NO.	DESCRIPTION	DESIGN	Date:
—	—	INITIAL RELEASE	Peter Wang	2018.04.09

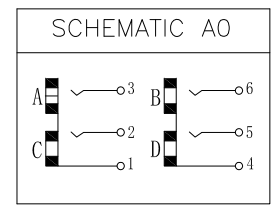
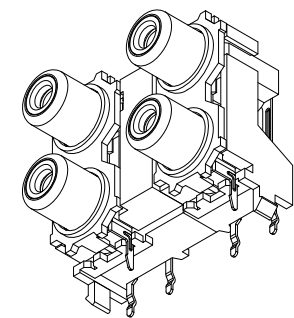
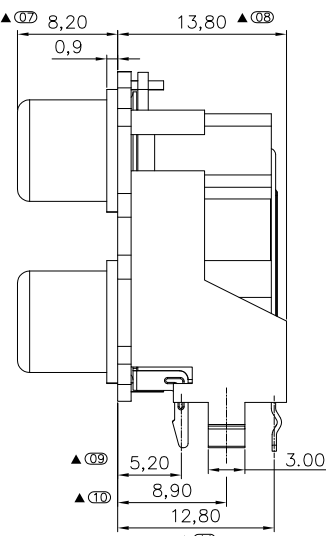
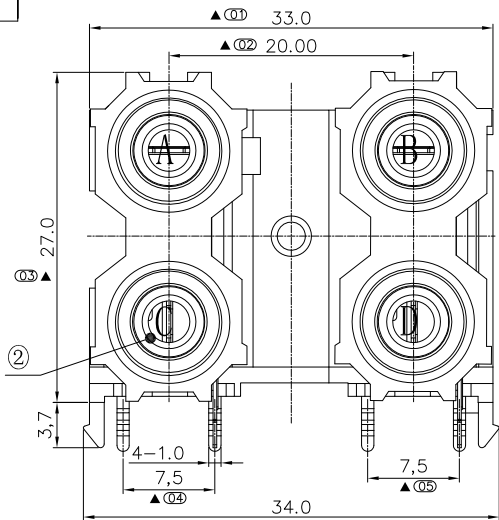

TABLE A: Circuit Code

2	B4	ABS	PBT 30%G/F UL94V-0	RoHS2&H.F Fit
1	B0	ABS	PBT 30%G/F UL94V-0	RoHS2 Fit
NO.	CODE	HOUSING	WASHER	REMARK

TABLE B : Plasting Material

01	BLK	BLK	BLK	BLK	10	WHT	WHT	RED	RED
02	WHT	WHT	WHT	WHT	11	YEL	YEL	WHT	WHT
03	YEL	YEL	YEL	YEL	12	WHT	WHT	YEL	YEL
04	GRN	GRN	GRN	GRN	13	RED	RED	BLK	RED
06	RED	RED	BLK	BLK	14	BLU	WHT	RED	RED
07	RED	BLK	BLK	RED	15	BLU	BLK	RED	RED
08	RED	WHT	ORN	YEL	16	BLK	RED	RED	RED
09	WHT	YEL	RED	ORN	17	WHT	YEL	RED	BLK
CHOOSE	A	B	C	D	CHOOSE	A	B	C	D

WHT:WHITE(白)
YEL:YELLOW(黄)
GRN:GREEN(绿)
BLK:BLACK(黑)
BLU:BLUE(蓝)
ORN:ORANGE(橘)
GRY:GRAY(灰)
RED:RED(红)
BRN:BROWN(棕)
BRN:BROWN(深棕)

TABLE C : Color Code of Washer

3	AG	Cu:40u"+Tin:80u"+Au:0.8u"(Min)	Cu:40u"+Tin:80u"Min	48Hours Salt
2	AB	Cu:40u"+Tin:80u"(Min)	Cu:40u"+Tin:80u"Min	48Hours Salt
1	A2	Cu:6u"+Tin:6u"(Min)	Cu:6u"+Tin:6u"Min	24Hours Salt
NO.	PLATING CODE	SHELL	TERMINAL	REMARK

TABLE D : Plating Code

- NOTES:
- Rating:DC12V 1.0A;
 - Contact Resistance:Before the test≤30milliohm, After the test≤50milliohm;
 - Insulation Resistance at DC500v:Before the test≥100megohm; After the test≥50megohm;
 - Withstand Voltage:AC500V for 1minutes;
 - Insertion and Extraction force:3~30N;
 - Life test:500 Cycles.
 - Operating temperature range:-25℃~+70℃ 85%RH MAX;
 - Storage Temperature Range:-40℃~+70℃ 85%RH MAX;
 - Sign"▲"is importance dimension.

Recommended PCB Board Hole

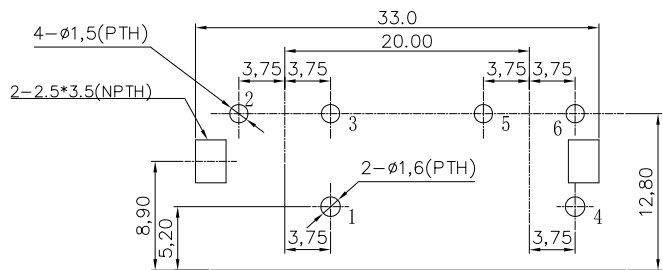

P/N: RC4126W-XXXX-XXXXXXX

Model P/N _____ Packing

Plasting Material _____ B:Tray

(Choose From Table B) _____ Remark

Washer Color _____ Shell Material

(Choose From Table C) _____ C:Brass C2680;

Circuit Code _____ Plating Code

(See Table A) _____ (Choose From Table D)

6	TERMINAL-2	2	Brass	CuSn PLATED	
5	TERMINAL-1	2	Brass	CuSn PLATED	
4	COVER	2	ABS	BLACK	
3	CAP	2	Brass	CuSn PLATED	
2	WASHER	4	Choose from P/N	Choose from P/N	
1	HOUSING	1	ABS	BLACK	
NO.	DESCRIPTION	QTY	PARTS MATERIAL	PLATING OR COLOR	REMARK

Tolerance	MODEL NAME:RCA PIN JACK	DRAWING: Peter Wang
X.X ±0.30	MODEL No:RC4126W-XXXX-XXXXXXX	CHECKED: David Zhou
X.XX ±0.20	REVISION A0	APPROVED: Jacky Lee
X.XXX ±0.10	SHEET 1/1	DATE: 2018.04.09
Angle ±3.0°	SCALE:1:1	FILE: F/LINGYANG
UNIT:mm	菱揚精密有限公司 Ling Yang Precision Co.,Ltd	DWG NO.RC4126W-A001

正式图 参考图

Mark	ECN NO.	DESCRIPTION	DESIGN	Date:
—	—	INITIAL RELEASE	Peter Wang	2018.04.09

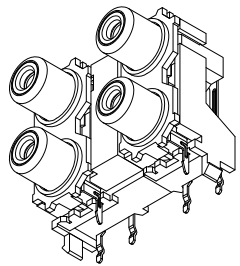

(一):
將產品擺放到托盤
48PCS/盤

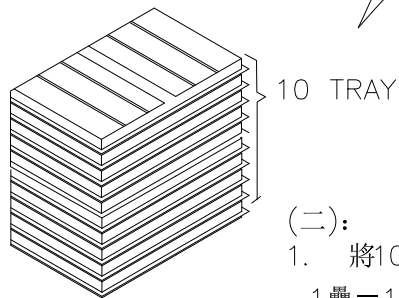
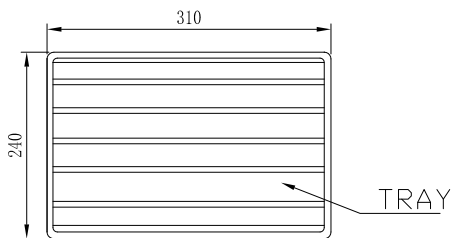

(二):
1. 將10盒產品疊放,最上層蓋放一空托盤
1疊=10盤*48=480PCS/疊

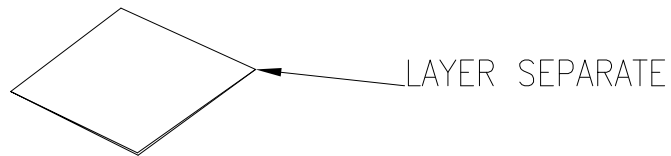

LAYER SEPARATE

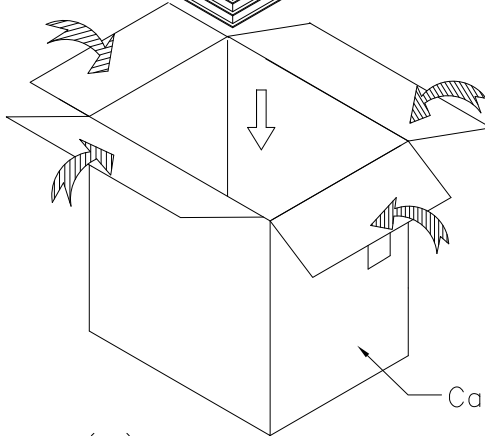
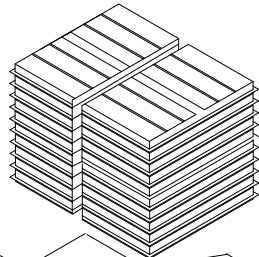

Carton

(三):
1. 將兩疊產品并排放置進紙箱,
2. 在紙箱上層如上示意圖放一層隔紙。
1箱=2疊*480=960PCS/箱

(四):
裝好產品好將紙箱H型封好膠帶
960PCS/箱

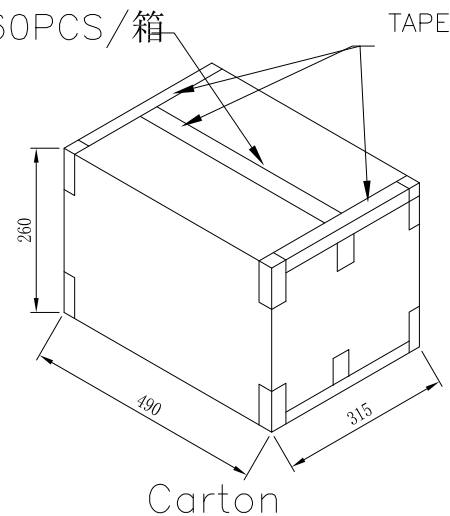

Carton

NO.	DESCRIPTION	QTY	PARTS MATERIAL	SIZE	WEIGHT
4	Products	960	X	According to product drawings.	Net weight: --KG
3	Layer separate	1	B=B	--	Gross weight: --KG
2	Tray	20	PET	310*240*26(mm)	
1	Carton	1	B=B	490*315*260(mm)	

Tolerance ±5	MODEL NAME:Packing specification			DRAWING: Peter Wang	
	MODEL No:RC4126W-XXXX-XXXXXXX			CHECKED: David zhou	
UNIT:mm	SCALE:1:1	REVISION A0	SHEET 1/1	APPROVED: Jacky Lee	
		DATE: 2018.04.09		FILE: F/LINGYANG	
菱揚精密有限公司 Ling Yang Precision Co.,Ltd				DWG NO. RC4126W-B001	